

WARNING

The information in this user manual is subject to change due to product updates or other reasons. This guide cannot replace the product labels or the safety precautions in the user manual unless otherwise specified. All descriptions in the manual are for guidance only.

01 Networking General Scenarios

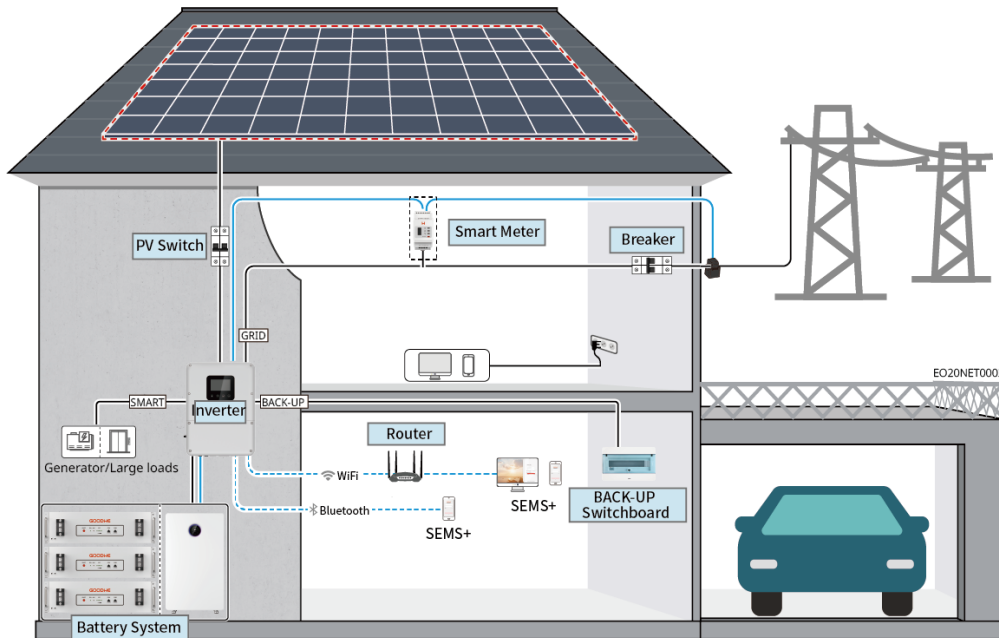

Device Type	Model	Description
Inverter	GW3K-EO-G20 GW3.6K-EO-G20 GW5K-EO-G20 GW6K-EO-G20	<ul style="list-style-type: none"> Supports connection to generator or large load If the Inverter needs to be compatible with GW16.1-BAT-LV-G10, the software version requirements are as follows: <ul style="list-style-type: none"> * DSP: Version 1.25 and above * ARM: Version 1.121 and above
Battery system	<ul style="list-style-type: none"> LX A5.0-10 LX A5.0-30 GW16.1-BAT-LV-G10 	<ul style="list-style-type: none"> Battery systems of different models cannot be mixed and used together. Expansion by clustering is temporarily not supported between different models. For the same model, expansion by clustering is allowed within one year of purchase and use, and not allowed after one year. After battery clustering and expansion, the charge and discharge SOC of the batteries may become unbalanced in the short term, which does not affect product safety and basic functions. The system will automatically perform balance correction. LX A5.0-10: Supports a maximum of 15 units clustered in the same system LX A5.0-30: Supports a maximum of 30 units clustered in the same system GW16.1-BAT-LV-G10: Supports a maximum of 30 units clustered in the same system
Lead-acid battery		<ul style="list-style-type: none"> Supports connection to AGM, GEL, and Flooded types of lead-acid batteries Calculate the number of batteries that can be connected in series based on the lead-acid battery voltage. The total voltage of series-connected batteries must not exceed 60V.
Smart Meter	Built-in meter (standard-equipped)	CT can be purchased from dealers or on your own. CT ratio requirement: 120A:40mA
	GMK110 (purchased from dealer)	<ul style="list-style-type: none"> When the length of the built-in CT cable of the inverter is insufficient to connect to the distribution board, it can be extended by externally connecting the GMK110 meter. GMK110: CT cannot be replaced; CT ratio: 120A/40mA
Heavy Load		Supports SG Ready. Large load specifications require: <ol style="list-style-type: none"> Total power of large load < Maximum output power of SMART port Large load power + BACK-UP power < Maximum AC input power (Utility grid)
Generator		Generator rated voltage must meet the rated voltage of the inverter SMART port

Device Type	Model	Description
Combiner box	BCB-11-WW-0 BCB-22-WW-0 BCB-32-WW-0 (purchased from GoodWe)	<ul style="list-style-type: none"> • When multiple batteries are used in the system, a combiner box can be optionally connected. If using batteries from other brands, please consult the corresponding manufacturer for the connection method between the battery and the busbar. • When a busbar or combiner box is used in the system to connect the battery and the inverter. (current \geq IBat rated. (IBat rated: battery maximum charge/discharge current). • BCB-11-WW-0: Used with LX A5.0-10, the battery system supports a maximum working current of 360A and a maximum connection of 6 batteries. • BCB-22-WW-0: <ul style="list-style-type: none"> * Used with LX A5.0-10, the battery system supports a maximum working current of 720A and a maximum connection of 12 batteries. * Used with LX A5.0-30, the battery system supports a maximum working current of 720A and a maximum connection of 6 batteries. • BCB-32-WW-0: <ul style="list-style-type: none"> * Used with LX A5.0-10, the battery system supports a maximum working current of 720A and a maximum connection of 15 batteries. * Used with LX A5.0-30, the battery system supports a maximum working current of 720A and a maximum connection of 15 batteries. * Used with GW16.1-BAT-LV-G10, the battery system supports a maximum working current of 720A and a maximum connection of 15 batteries. • Others: Please configure according to the system power and current.

Steps	1 Installation	2 PE	3 PV	4 Battery	5 AC	6 COM
Inverter						
Tools	D: 80mm Φ: 8mm	M5 1.5-2N·m	 	1 M8 5N·m 2 M25 5-6N·m	2 1.5N·m 3 M25 5-6N·m 4 M22 5N·m	2 M2 0.2-0.3N·m 4 M22 5N·m 5 M25 5-6N·m

Steps	1 Installation						2 PE	3 Battery	4 COM	
Battery	LX A5.0-10			LX A5.0-30			LX A5.0-10 LX A5.0-30	LX A5.0-10 LX A5.0-30	LX A5.0-10 LX A5.0-30	
Tools			1 2 3			1 2 3	M5 4N·m	M6 6N·m	M8 12N·m	
	M4 1.4N·m	M6 6N·m	2 M6 6N·m 3 M5 4N·m	M4 1.4N·m	M6 6N·m	2 M6 6N·m 3 M4 1.4N·m				

Steps	1 Installation		2 PE	3 Battery	4 COM
Battery	GW16.1-BAT-LV-G10		GW16.1-BAT-LV-G10	GW16.1-BAT-LV-G10	GW16.1-BAT-LV-G10
Tools					

Steps	1 Installation	2 Cable Connections	3 Power	4 Commissioning
Smart meter	GMK110	GMK110	AC breaker	

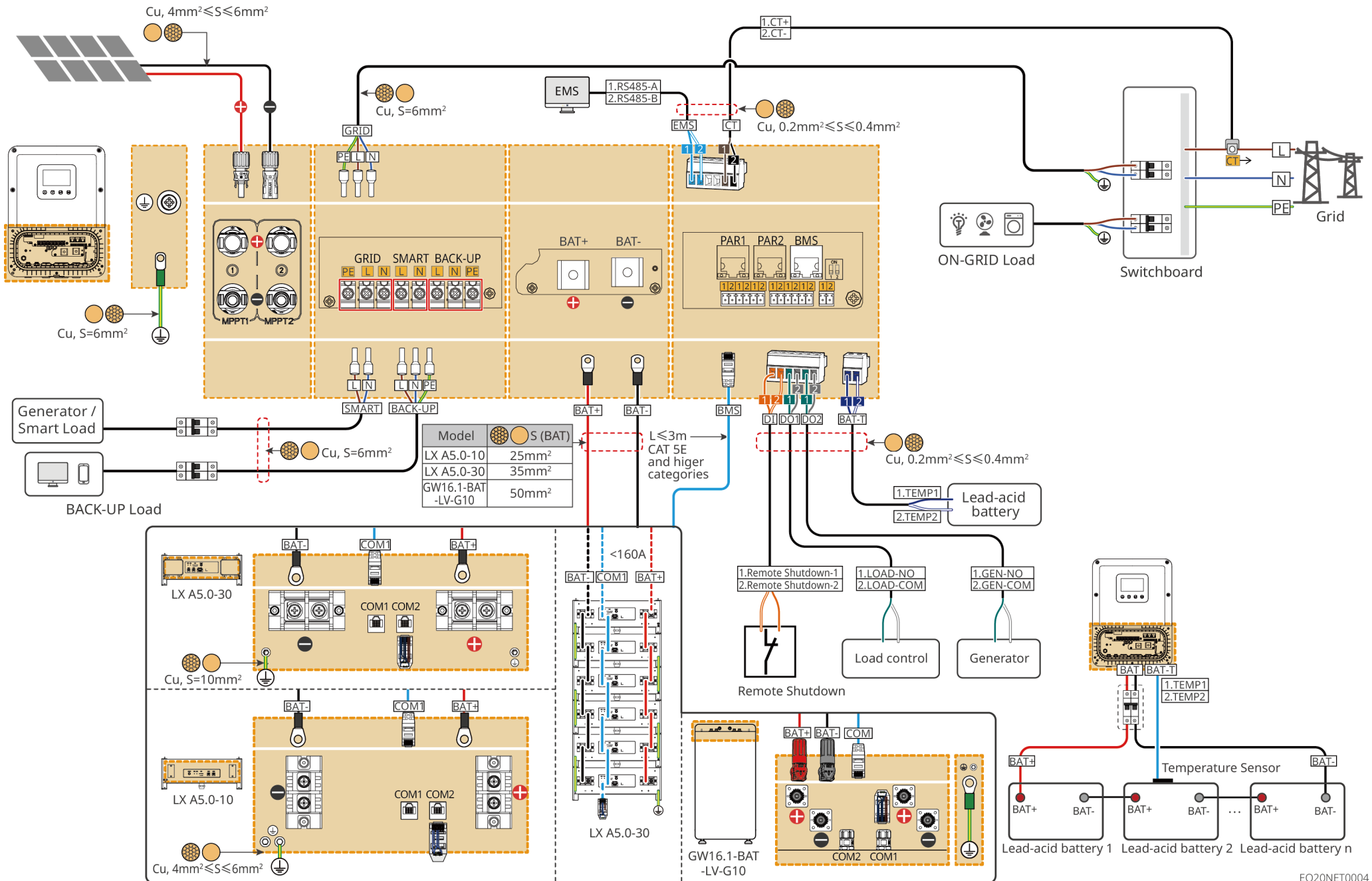

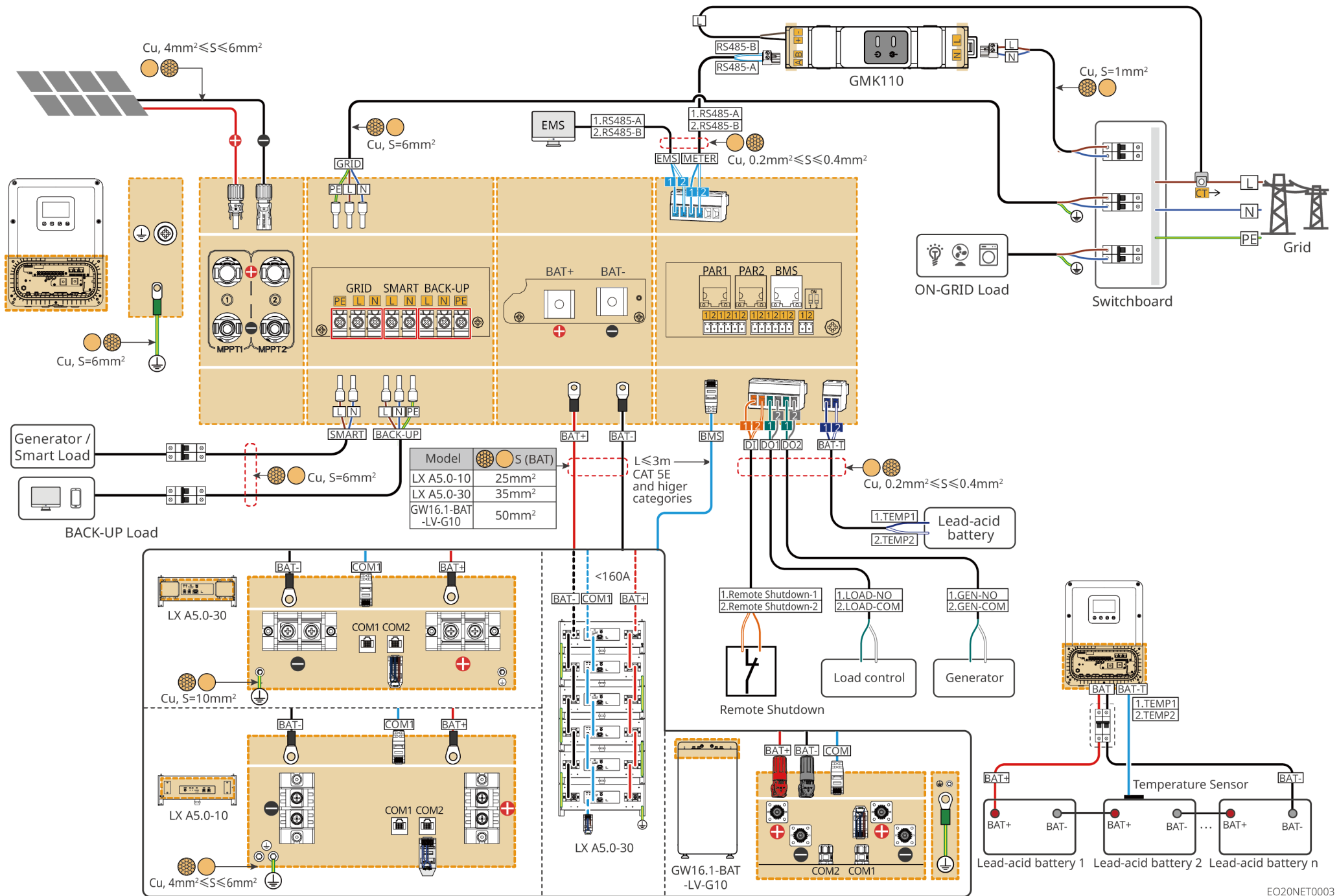

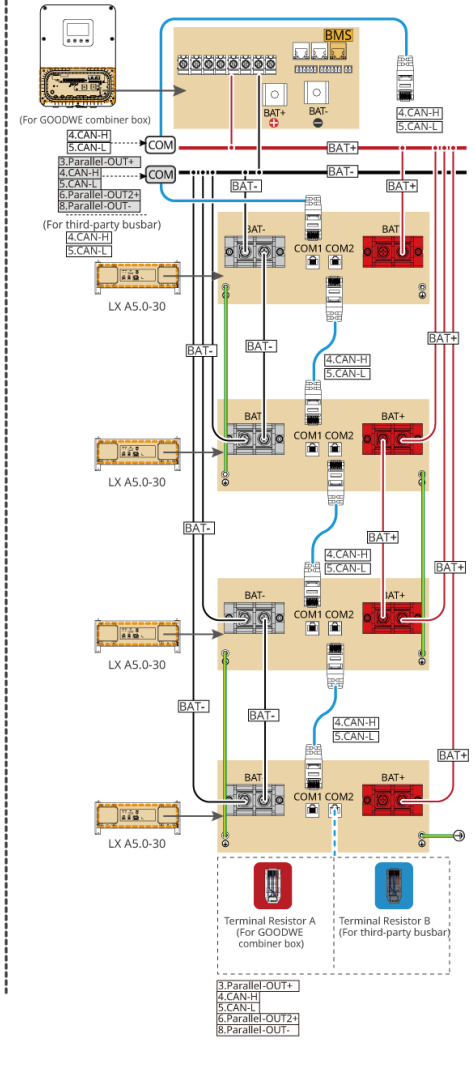
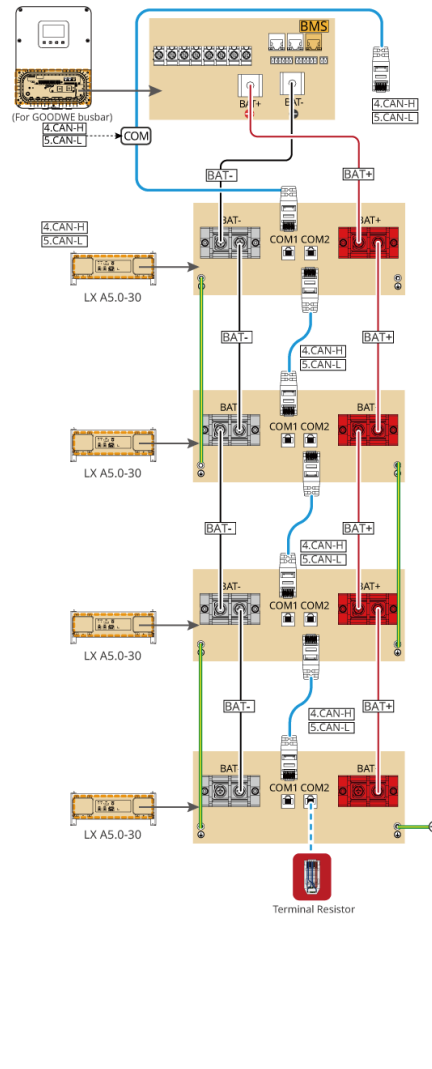
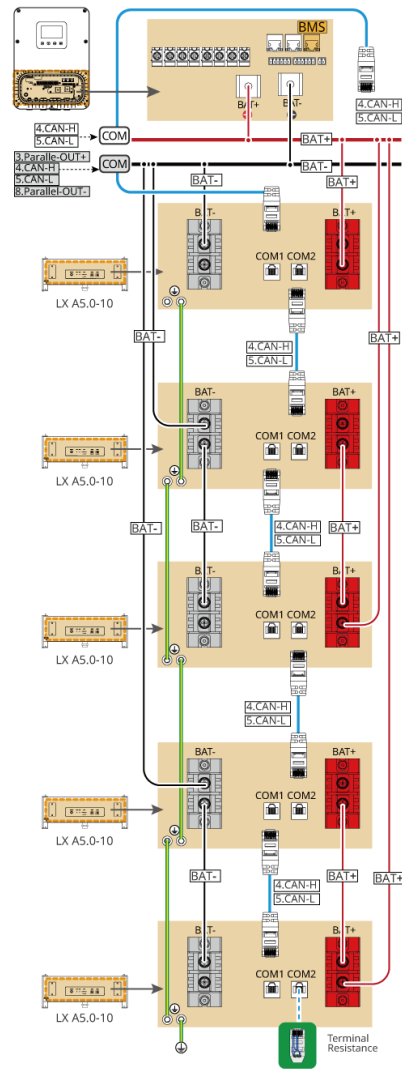
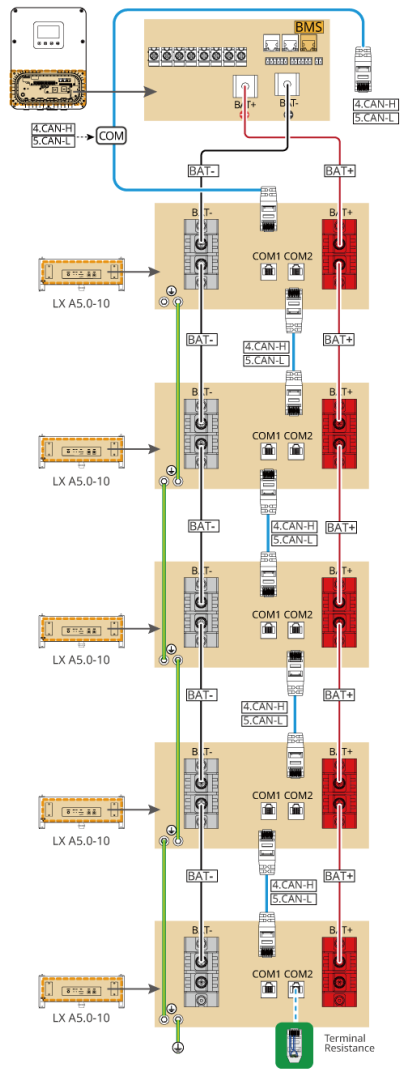

— CAT 5E and higher categories

EO20ELC0010

04 Power On/Off

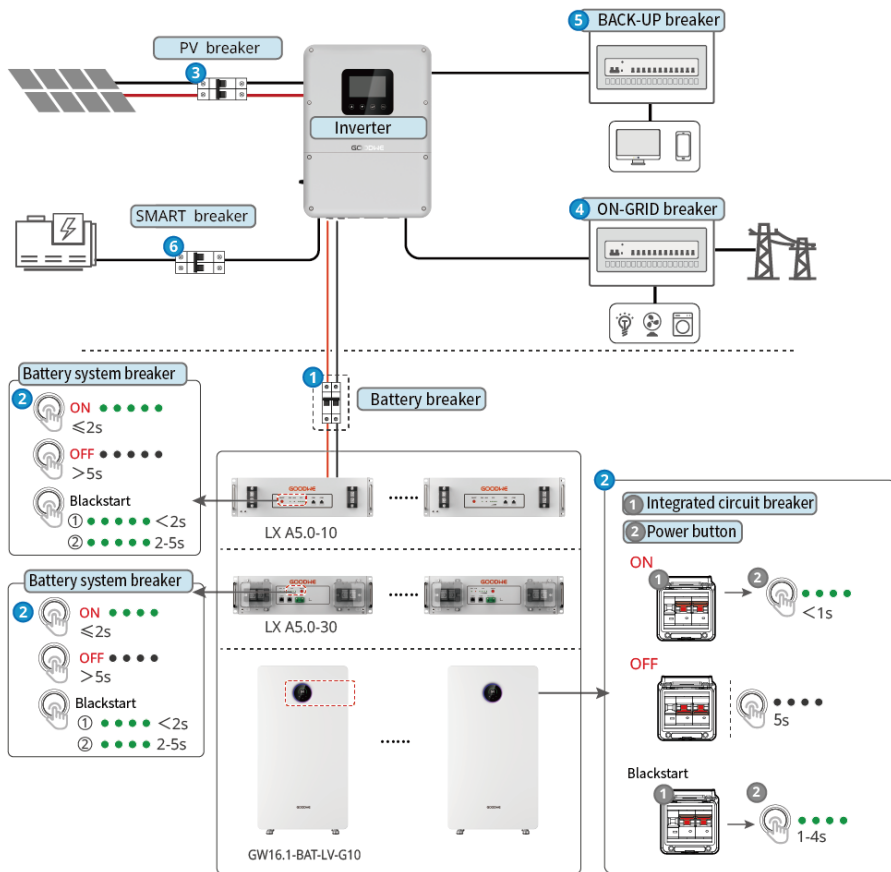

Power On: ① → ② → ③ → ④ → ⑤ → ⑥

Power Off: ⑤ → ⑥ → ③ → ① → ② → ③

EO20PWR002

05 Commissioning



SEMS+ App



SEMS+ App User Manual

Download and open the App, then connect to the inverter signal following on-screen prompts.

Network Settings

Access the LCD main interface, tap > **Quick Settings** > **Communication Module Settings**, and enable the inverter Bluetooth signal.

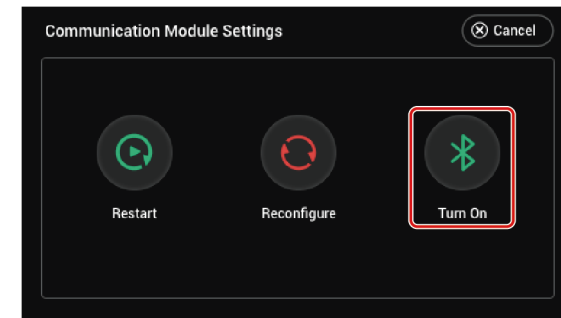

EO20CON0021

Tap the SEMS+ App interface to set network parameters.

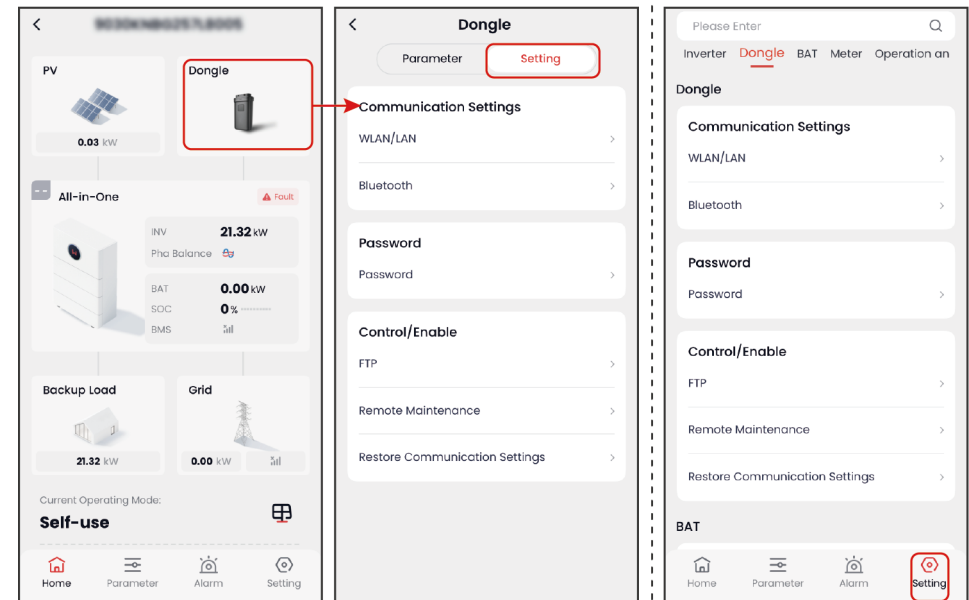

SEMS0155

Quick Settings

Method 1: Tap Quick Configuration on SEMS+ App and finish Quick Settings of the inverter as prompted.

Method 2: Set via LCD screen. Operate by screen touch or button. Enter  > **Quick Settings** and complete inverter quick setup following on-screen instructions.

Initial password for Advanced function page: 1111

Quick Settings Via APP

Configure network, safety regulations and operating modes via SEMS+

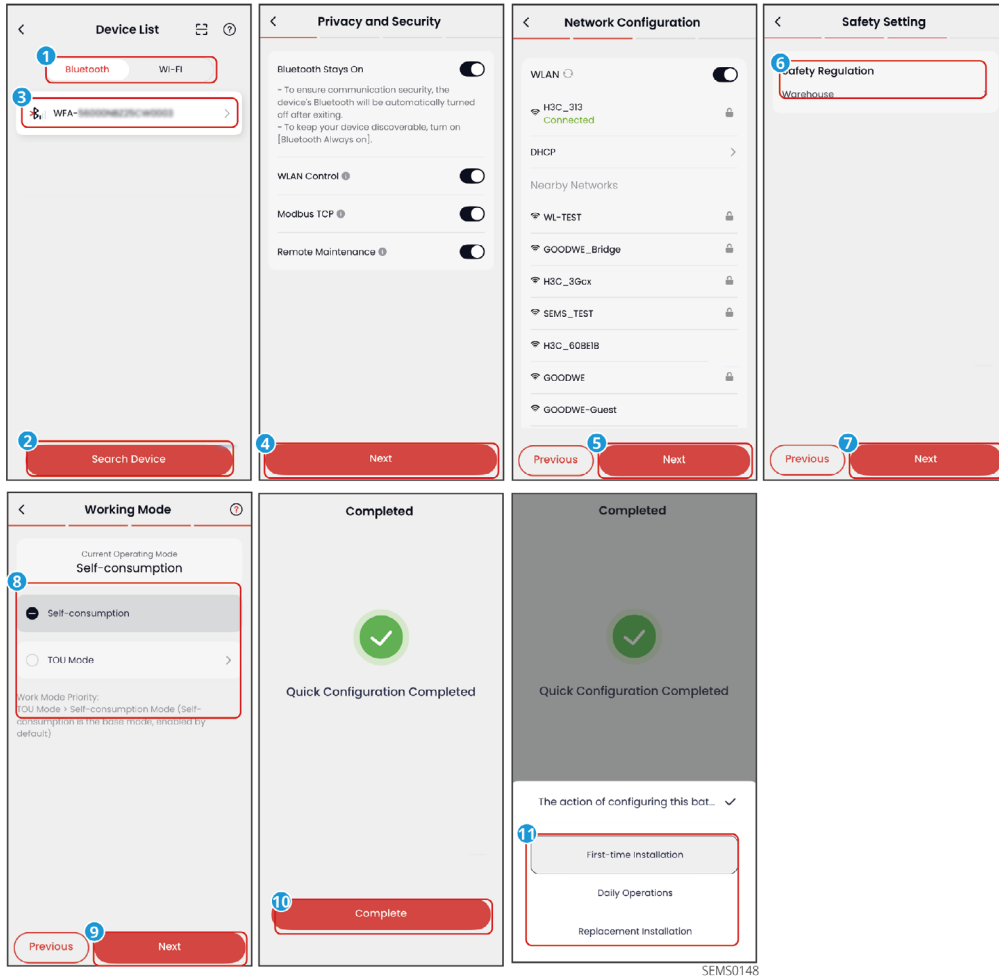

SEMS0148

Quick Settings Via LCD

Set safety standards and grid type

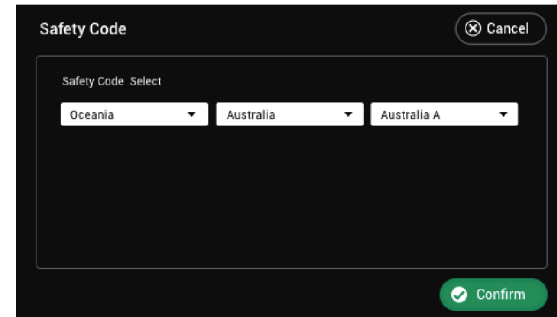

EO20CON0012

Set operating mode

Self-use Mode

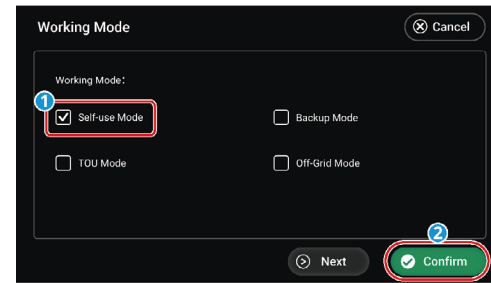

ET110CON0014

Backup Mode

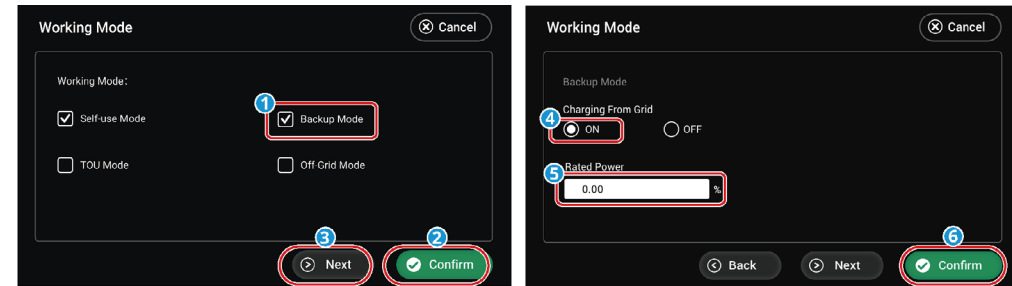

ESU10CON0015

TOU Mode

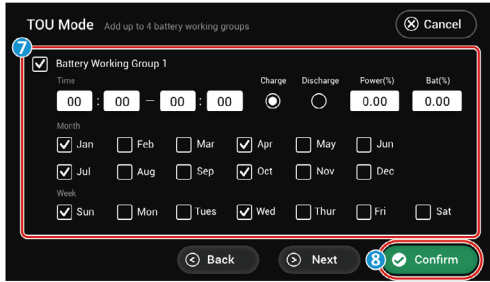
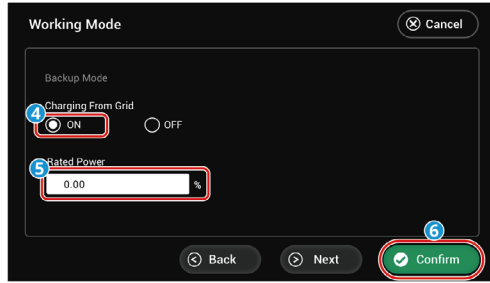
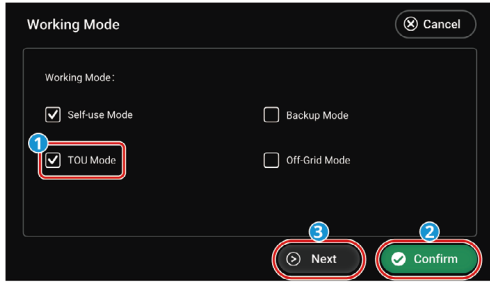

ETL10CON0008

Off-Grid Mode

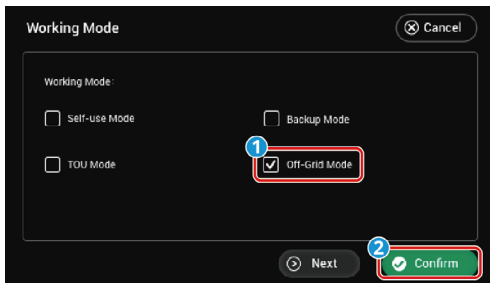

EO20CON0020

Set battery parameters

Set lithium battery parameters

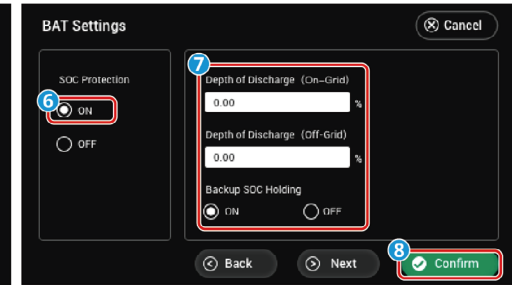
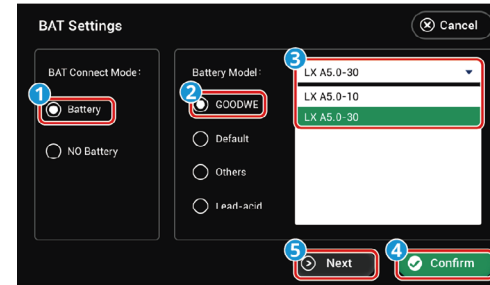

EO20CON0013

Set lead-acid battery parameters

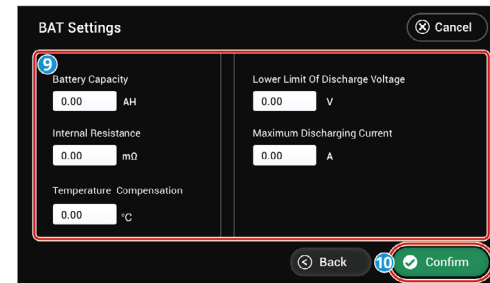
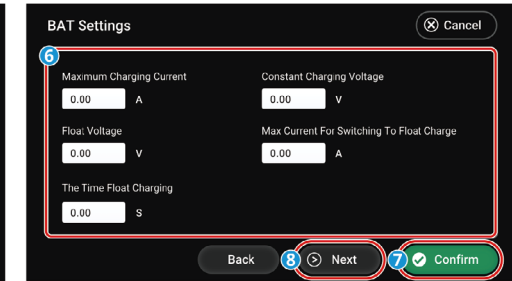
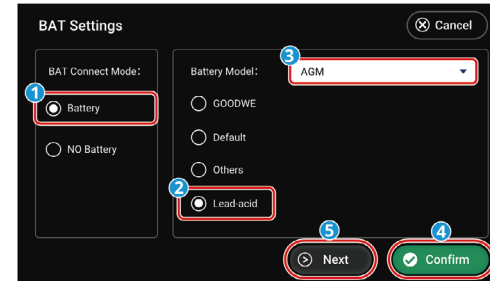

ESU10CON0011

PV Access Mode

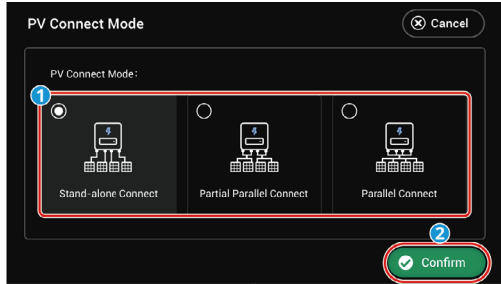

ESU10CON0015

PV Access Mode

Set PV Access Mode via App.

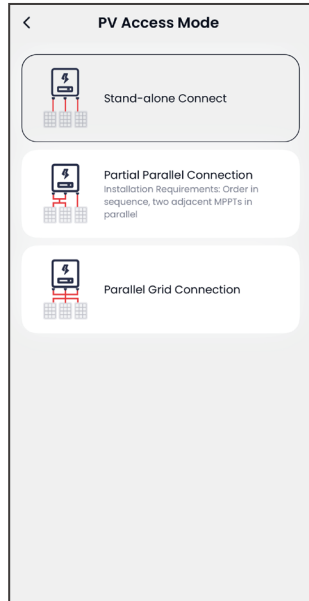

Complete power station creation and device addition operations via SEMS+ App.

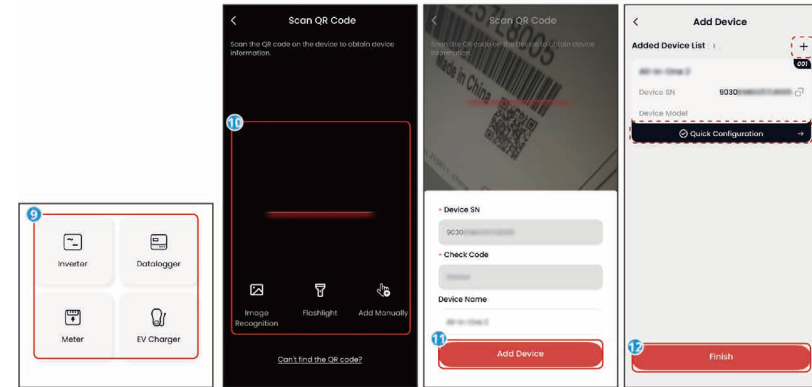
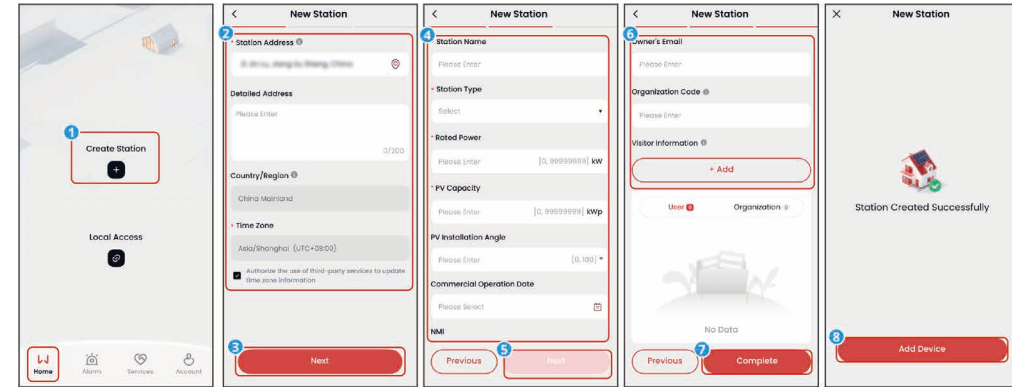

SEMS0176

GoodWe Technologies Co., Ltd.

No. 90 Zijin Rd., New District, Suzhou, 215011, China

www.goodwe.com

service@goodwe.com